

Latimea danturii "h" per modul: 20 mm

Latimea totala "H" per modul: 35 mm

Unghi de angrenare: 20°

Material: otel C45E-UNI EN 10083-1

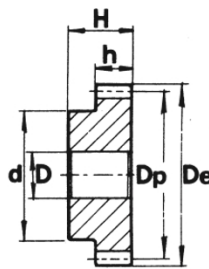
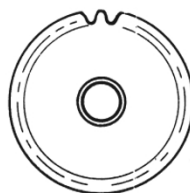

Z (numar de dinti)	Cod	De (mm)	Dp (mm)	d (mm)	D (mm)
12	PM 28012	28	24	18	10
13	PM 28013	30	26	19	10
14	PM 28014	32	28	20	10
15	PM 28015	34	30	22	10
16	PM 28016	36	32	24	10
17	PM 28017	38	34	25	10
18	PM 28018	40	36	25	10
19	PM 28019	42	38	25	10
20	PM 28020	44	40	30	10
21	PM 28021	46	42	30	12
22	PM 28022	48	44	30	12
23	PM 28023	50	46	30	12
24	PM 28024	52	48	35	12
25	PM 28025	54	50	35	12
26	PM 28026	56	52	40	12
27	PM 28027	58	54	40	12
28	PM 28028	60	56	40	12
29	PM 28029	62	58	40	14
30	PM 28030	64	60	40	14
31	PM 28031	66	62	45	14
32	PM 28032	68	64	45	14
33	PM 28033	70	66	45	14
34	PM 28034	72	68	45	14
35	PM 28035	74	70	45	14
36	PM 28036	76	72	45	14
37	PM 28037	78	74	50	14
38	PM 28038	80	76	50	14
39	PM 28039	82	78	50	14
40	PM 28040	84	80	50	14
41	PM 28041	86	82	60	16
42	PM 28042	88	84	60	16
43	PM 28043	90	86	60	16
44	PM 28044	92	88	60	16
45	PM 28045	94	90	60	16
46	PM 28046	96	92	60	16

Z (numar de dinti)	Cod	De (mm)	Dp (mm)	d (mm)	D (mm)
47	PM 28047	98	94	60	16
48	PM 28048	100	96	70	16
49	PM 28049	102	98	70	16
50	PM 28050	104	100	70	16
51	PM 28051	106	102	70	20
52	PM 28052	108	104	70	20
53	PM 28053	110	106	70	20
54	PM 28054	112	108	70	20
55	PM 28055	114	110	70	20
56	PM 28056	116	112	70	20
57	PM 28057	118	114	70	20
58	PM 28058	120	116	70	20
59	PM 28059	122	118	70	20
60	PM 28060	124	120	70	20
61	PM 28061	126	122	80	20
62	PM 28062	128	124	80	20
63	PM 28063	130	126	80	20
64	PM 28064	132	128	80	20
65	PM 28065	134	130	80	20
66	PM 28066	136	132	80	20
67	PM 28067	138	134	80	20
68	PM 28068	140	136	80	20
69	PM 28069	142	138	80	20
70	PM 28070	144	140	80	20
72	PM 28072	148	144	80	20
85	PM 28085	174	170	80	20